



Keystone Face Plate for 1 Module

Technical Features

Flush-mounted Installation

80 x 80 (50 x 50mm) designed with metal frame

45° downward angled with shutter

Technical Drawing

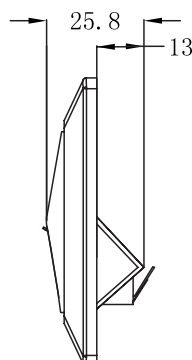
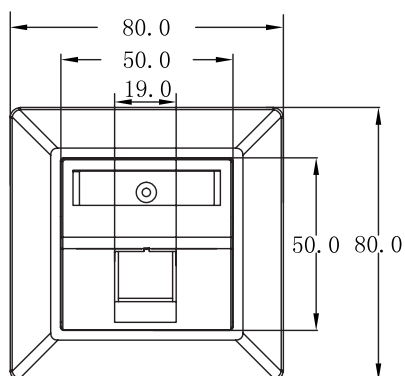
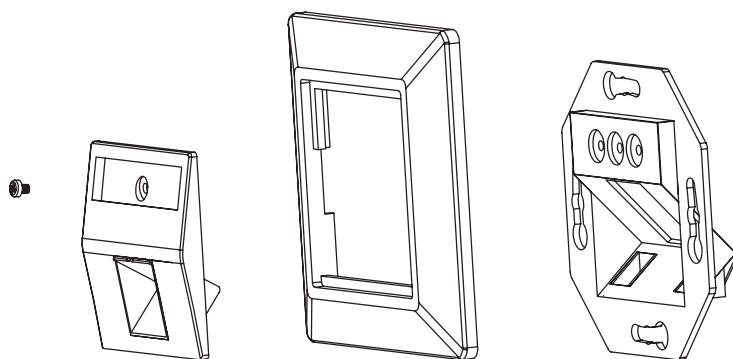

Materials:

1. Outlet Housing: ABS UL-94V2
2. Outlet Base: ABS UL-94V2
3. Metallic Plate: Al & Zn Alloy

Part no.	Color	EAN Code
NK4026	RAL9003 Signal White	4052792060775
NK4027	RAL9010 Pure White	4052792060782

Package Content

Keystone Face Plate for 1 Module x 1

Packaging Information

Packing Dimension	120 x 110mm
Packing Weight	0.079kg
Carton Dimension	530 x 320 x 230mm
Carton Q'ty	120pcs
Carton Weight	10.5kg

